

- Features:
1. 4~16 circuits available;
 2. Material: PA46 UL 94V-0;
 3. Accepts H250011-XX terminal;
 4. Mates with H250013, H250014, H250015;
 5. Color: Black/Natural

Specification:

Current rating: 8A at 10A .
 Voltage rating: 400V AC or 400V DC Max.
 Contact resistance: 10mΩ Max.
 Insulation resistance: 100MΩ Min.
 Withstanding voltage: 1800VAC/minute.
 Ambient temperature range: -40°C~105°C.

Dimensional information (mm)

| Circuits | DIM A | DIM B |
|----------|-------|-------|
| 4 | 7.70 | 2.50 |
| 6 | 10.20 | 5.00 |
| 8 | 12.70 | 7.50 |
| 10 | 15.20 | 10.00 |
| 12 | 17.70 | 12.50 |
| 14 | 20.20 | 15.00 |
| 16 | 22.70 | 17.50 |

H250012-XX-X
 SERIES NO: _____
 PIN Q'PY: _____
 04~16
 A-BLACK (KEY A)
 B-NATURE (KEY B)

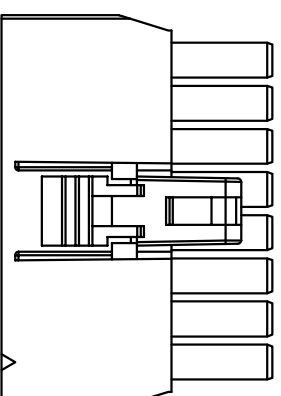
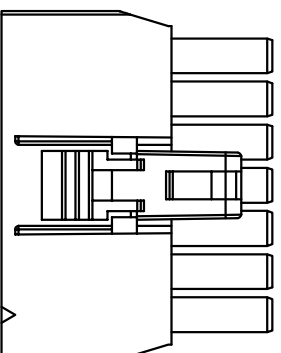
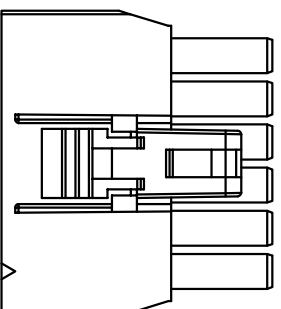
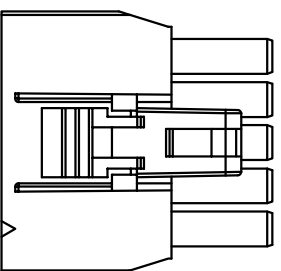
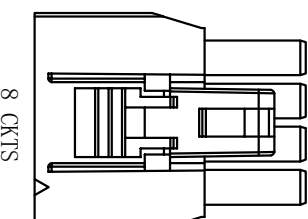
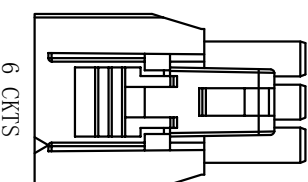
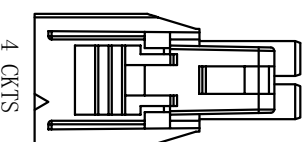
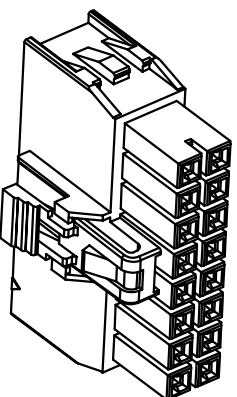
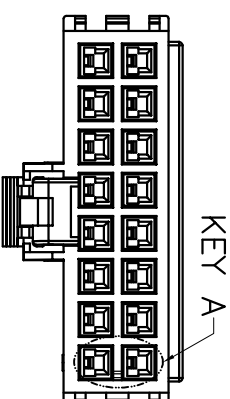
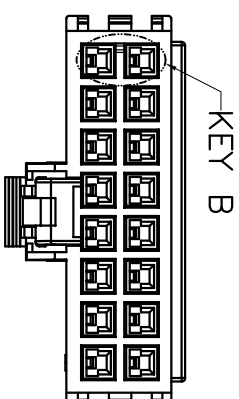
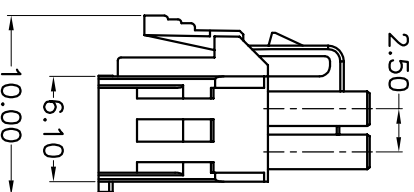
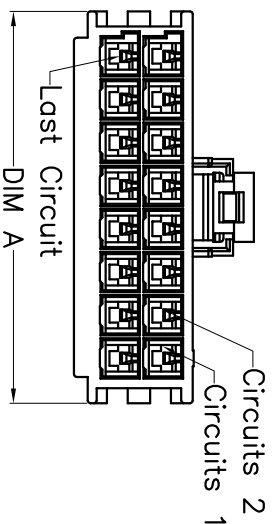
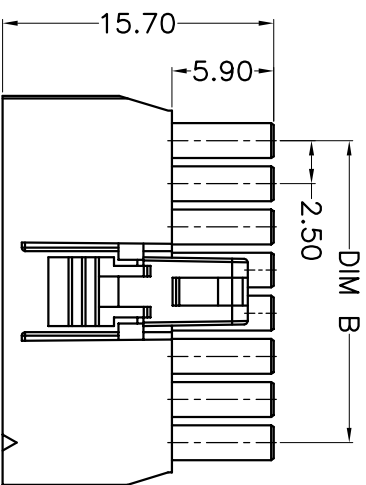

10 CKTS

12 CKTS

14 CKTS

16 CKTS

| REV | Description | DATE | GENERAL TOLERANCES (Unless specified) | UNITS | MM | DATE | DRAWING | PRODUCT NAME | PART NUMBER |
|-----|-------------|------------|--|-------|-----|------------|-------------|---|--------------|
| A | 新版发行 | 2018-06-05 | X.X±0.4 | SCALE | 1:1 | 2018-03-05 | Liu zhi guo | DONG GUAN SHI HENG CHUANG CONNECTOR COMPANY LIMITED | H250012-XX-X |
| | | | X.XX±0.25 | REV | A | | Li peng | | |
| | | | X.XXX±0.15 | | | | | | |

东莞市恒创连接器有限公司

DONG GUAN SHI HENG CHUANG CONNECTOR COMPANY LIMITED

2.5mm dual row wire to Board housing

H250012-XX-X

- Features:
1. Material: High conductivity copper alloy;
 2. Finished: Tin-plated over nickel or G/F 0.8U";
 3. Used in H250012 H2500S12
 4. Wire range: #20~#26 AWG

Specification:

Current rating: 8A at 10A .
 Voltage rating: 400V AC (RMS) or 400V DC Max.
 Contact resistance: 10mΩ Max.
 Insulation resistance: 100MΩ Min.
 Withstanding voltage: 1800VAC/minute.
 Ambient temperature range: -40°C~105°C.

Ordering Information

| Part NO | Wire range | DIM A | DIM B | DIM C | DIM D |
|---------|------------|-------|-------|-------|-------|
| 01 | #20~#22 | 1.50 | 2.15 | 2.00 | 2.15 |
| 02 | #24~#26 | 1.40 | 2.15 | 2.00 | 1.45 |

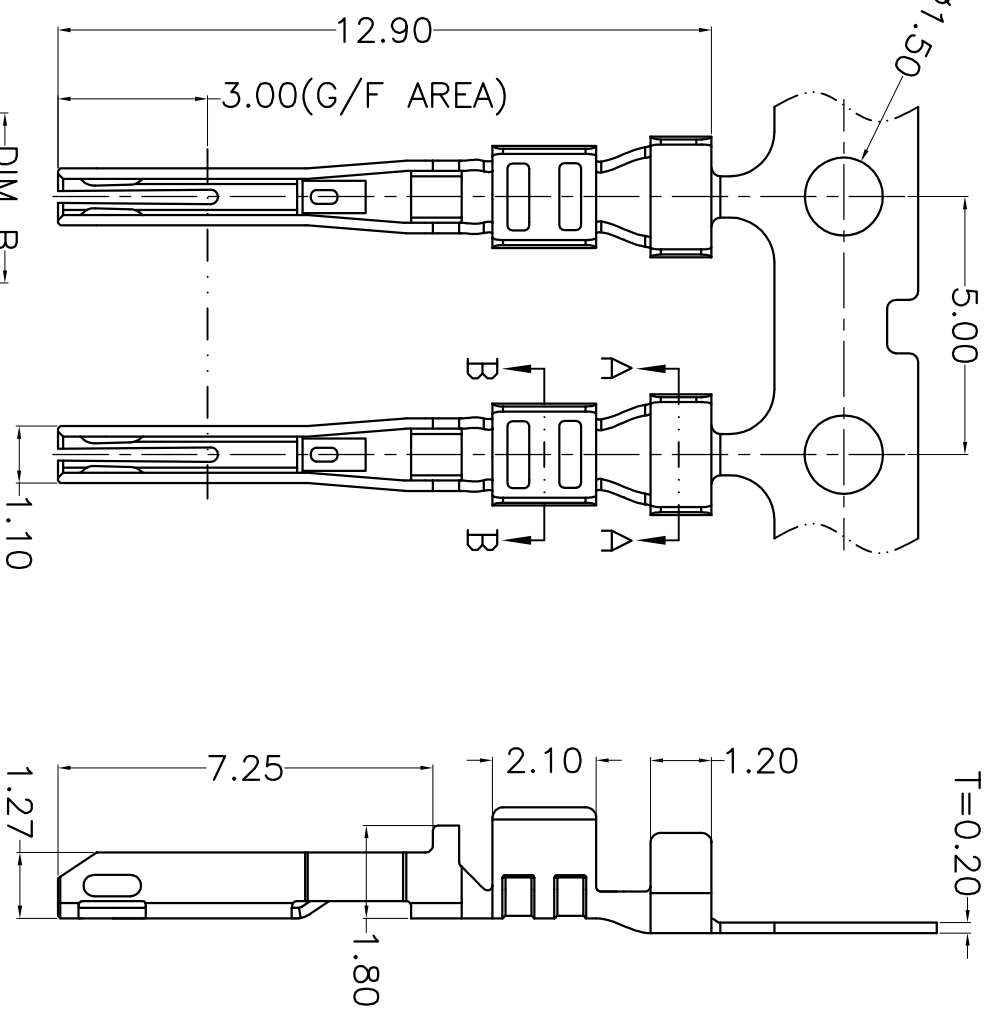

H250011-XX-XX

SERIES NO: _____

Wire range: _____
 01: #20~#22
 02: #24~#26

PLATING:
 0T-Tin-plated
 G0-G/F 0.8U"

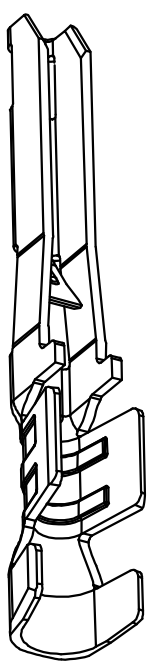
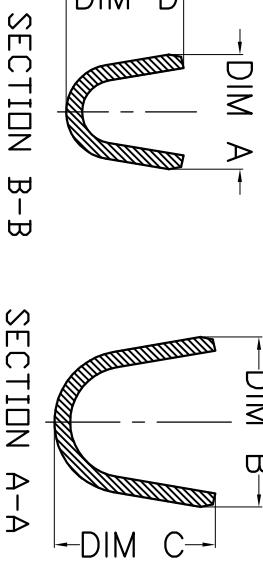

| REV | Description | DATE | GENERAL TOLERANCES (unless specified) | UNITS | MM | DATE | DRAWING | PRODUCT NAME |
|-----|-------------|------------|---------------------------------------|-------|-----|------------|-------------|-------------------------------|
| A | 新版发行 | 2018-06-05 | X.X±0.4 | SCALE | 1:1 | 2018-03-05 | Liu zhi guo | 东莞市恒创连接器有限公司 |
| B | 删除管控尺寸4.7尺寸 | 2025-01-13 | X.XX±0.25 | REV | A | | Li peng | 2.5 mm wire to Board Terminal |

| DONG GUAN SHI HENG CHUANG CONNECTOR COMPANY LIMITED | | PART NUMBER | |
|---|--|---------------|--|
| X.XXX±0.15 | | H250011-XX-XX | |

东莞市恒创连接器有限公司

2.5 mm wire to Board Terminal